

Forged Steel Flanges

Carbon Steel • Stainless Steel • Special Alloys

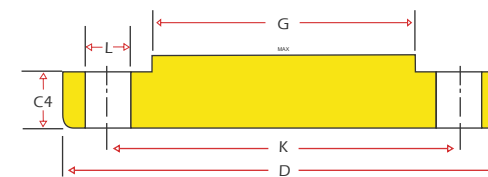
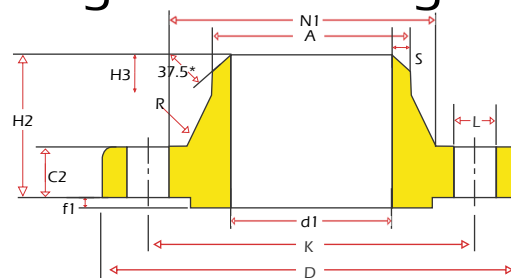
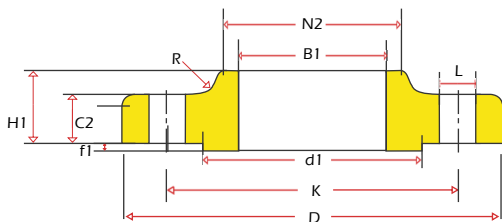

40 BAR Acc. to EN 1092-1

TYPE 12 SLIP-ON FLANGES

TYPE 11 WELD NECK FLANGES

TYPE 05 BLIND FLANGES

Nominal Pipe Size	Outside Diameter	Pitch Circle Diameter	Size of Bolts	No. of Holes	Flange Thickness		Length of Flanges			Corner Radius	Outside Diameter of Neck	Neck Diameter		Diameter of Shoulder		Raised Face Thickness	Neck Thickness			
					Flange Type															
					11 & 12	05	11, 12 & 05	11 & 12	11 & 12	11, 12 & 05	11	11 & 12	11 & 12	11	05	11, 12 & 05	11			
C2	C4	H1	H2	H3	R	A	N1	N2	d1	G	f1	S								
15	95	65	M12	4	16	16	22	38	6	4	21.3	32	35	45	-	2	2.0			
20	105	75	M12	4	16	18	26	40	6	4	26.9	40	45	58	-	2	2.3			
25	115	85	M12	4	18	18	28	40	6	4	33.7	46	52	68	-	2	2.6			
32	140	100	M16	4	18	18	30	42	6	6	42.4	56	60	78	-	2	2.6			
40	150	110	M16	4	18	18	32	45	7	6	48.3	64	70	88	-	2	2.6			
50	165	125	M16	4	20	20	34	48	8	6	60.3	75	84	102	-	2	2.9			
65	185	145	M16	8	22	22	38	52	10	6	*76.1	90	104	122	55	2	2.9			
80	200	160	M16	8	24	24	40	58	12	8	88.9	105	118	138	70	2	3.2			
100	235	190	M20	8	24	24	44	65	12	8	114.3	134	145	162	90	2	3.6			
125	270	220	M24	8	26	26	48	68	12	8	*139.7	162	170	188	115	2	4.2			
150	300	250	M24	8	28	28	52	75	12	10	*168.3	192	200	218	140	2	4.5			
200	375	320	M27	12	34	36	52	88	16	10	219.1	244	260	285	190	2	6.3			
250	450	385	M30	12	38	38	60	105	18	12	273.0	306	312	345	235	2	7.1			
300	515	450	M30	16	42	42	67	115	18	12	323.9	362	380	410	285	2	8.0			
350	580	510	M33	16	46	46	72	125	20	12	355.6	408	424	465	330	2	8.8			
400	660	585	M36	16	50	50	78	135	20	12	406.4	462	478	535	380	2	11.0			
450	685	610	M36	20	57	57	84	135	20	12	457.0	500	522	560	425	2	12.5			
500	755	670	M39	20	57	57	90	140	20	12	508.0	562	576	615	475	2	14.2			
600	890	795	M45	20	72	72	100	150	20	12	610.0	666	686	735	575	2	16.0			

* All dimensions in mm.

* All weights indicated are approximate

Other sizes available on request.

* The OD of the neck is suitable for ASTM A106 Piping

* For BS Standards Piping dimensions shall be 65mm = 76.1mm, 125mm = 139.7mm, 150mm = 168.3mm